

ASSEMBLY NOTES:

1. USE PERMANENT THREADLOCKER (LOCTITE 262 OR EQUIVALENT) ON ITEMS 3, 5 AND 6.
2. SILVER SOLDER ASSEMBLED JOINTS AND POLISH SMOOTH.
3. DURING FINAL ASSEMBLY: APPLY THIN LAYER OF (LOCTITE 404) AFTER O-RINGS ARE INSTALLED AND JUST BEFORE THE BAR.

BILL OF MATERIAL

ITEM	PT/ASSY	DESCRIPTION	TYPE	QTY.	DWG.NO.
1	454B	MOUNTING FLANGE	PART	2	HTL-049
2	4500	ROSETTE	PART	2	45A-003
3	4540SP	HOTEL SHELF POST	PART	2	HTL-050
4	4540LPL	HOTEL SHELF POST LEFT (LONG)	PART	1	HTL-052
5	4550F	POST FLANGE	PART	6	45A-005
6	4540-43ADP	THREAD EXTENSION	PART	2	HTL-051
7	4543DT	DOWN TUBE	PART	2	HTL-054
8	4540	TOWEL BAR BALL END	PART	2	HTL-055
9	4540LPR	HOTEL SHELF POST RIGHT (LONG)	PART	1	HTL-052
10	SM5-5S	M5 x5 STAINLESS STEEL SET SCREW	PART	2	-
11	454324	HOTEL SHELF TUBES	PART	1	HTL-054
12	454024	SIDE TUBE	PART	2	HTL-053
13	45408	CROSS TUBE	PART	11	HTL-054
14	10_1-5_PFS	No. 10 x 1-1/2" P H S.S. SELF TAPPING	PART	6	-
15	GCA	NO. 8 -10 WALL ANCHOR PLASTIC	PART	6	-
16	M2_5HK	2.5MM ALLOY STEEL HEX KEY	PART	1	-
17	RM16-1	16mm x 1mm BUNA-N- O-RING	PART	6	-
18	SSPM	DRYWALL ANCHOR	PART	6	-

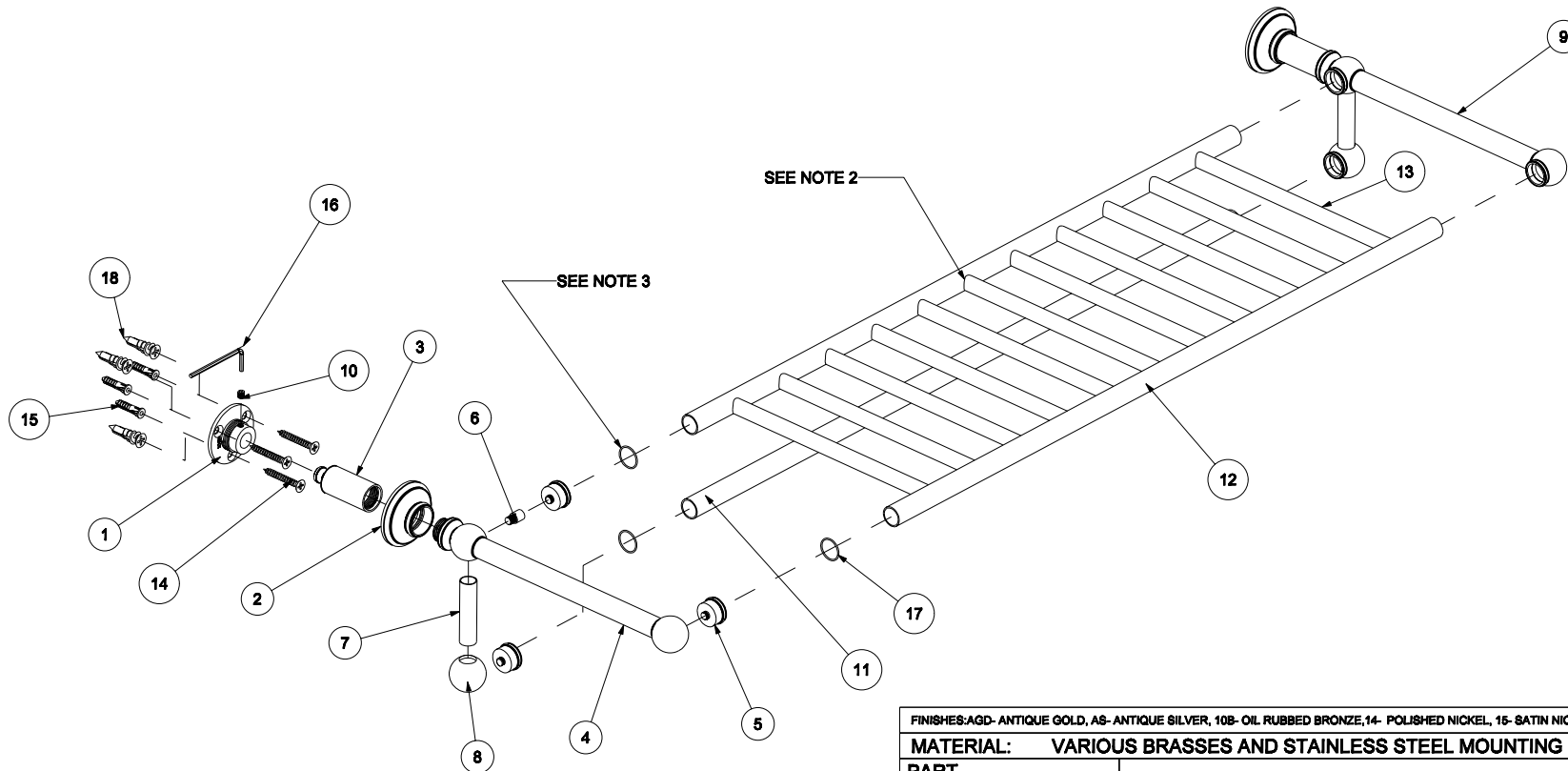

FINISHES:AGD- ANTIQUE GOLD, AS- ANTIQUE SILVER, 10B- OIL RUBBED BRONZE,14- POLISHED NICKEL, 15- SATIN NICKEL, 26 POLISHED CHROME

MATERIAL: VARIOUS BRASSES AND STAINLESS STEEL MOUNTING HARDWARE

PART NO. 4543-24 24" COLUMNAR HOTEL SHELF W/ TOWEL BAR

DATE:11.27.06

REV.DATE: 4.3.07

REV.B

SCALE 1

COLUMNAR

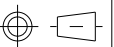

GINGER

DWG.NO.

4543-24

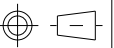
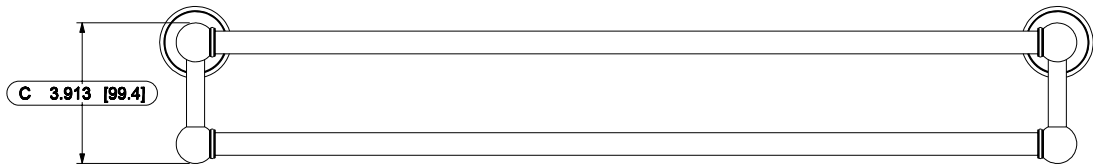
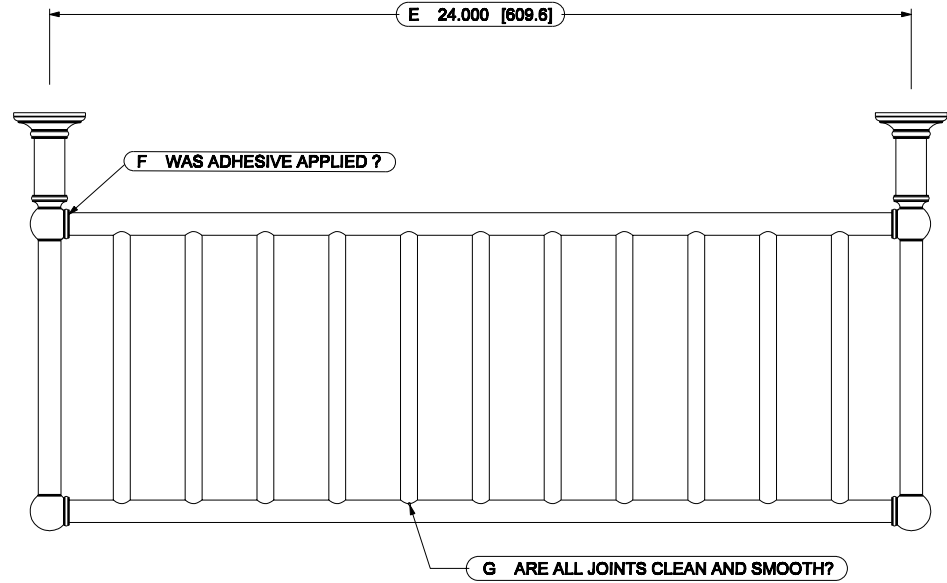
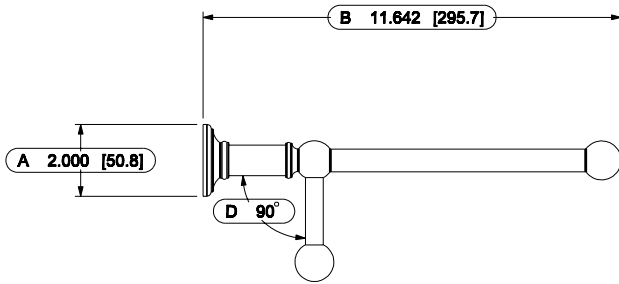

FINISHES:AGD- ANTIQUE GOLD, AS- ANTIQUE SILVER, 10B- OIL RUBBED BRONZE,14- POLISHED NICKEL, 15- SATIN NICKEL, 26 POLISHED CHROME

MATERIAL: VARIOUS BRASSES AND STAINLESS STEEL MOUNTING HARDWARE

PART NO. 4543-24 24" COLUMNAR HOTEL SHELF W/ TOWEL BAR

DATE:11.27.06 REV.DATE: 4.3.07 REV.B SCALE 3:16 COLUMNAR

GINGER

DWG.NO.

4543-24