

FLATIRON MUS-657GDSB



*Custom ADA compliant versions are available

- FEATURES**
 16-gauge type 304 stainless steel
 90° zero radius design
- TECHNICAL INFORMATION**
 External dimension: 38"Lx18.5"Wx10"D
 Basin dimensions: 36"Lx16.5"Wx10"D
- FINISHES**
 Gold PVD Satin Brushed stainless steel
- INSTALLATION OPTIONS**
 Top-mount
 Under-mount
- MINIMUM CABINET SIZE (I.D.)**
 Top-mount 40"
 Under-mount 42"

DUAL-MOUNT INSTALLATION

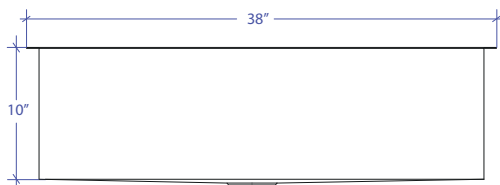
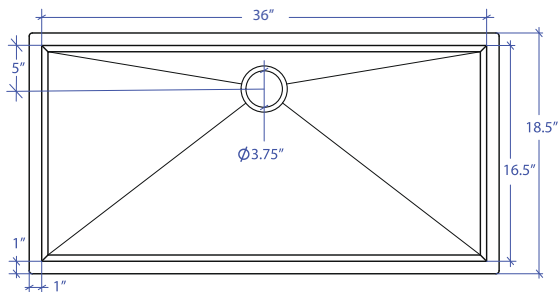
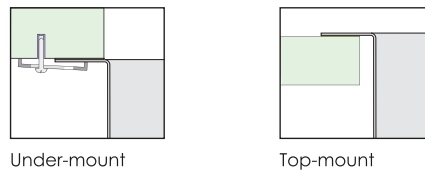

ACCESSORY OPTIONS

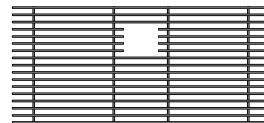

MBG-6518GDSB
Basin Grid

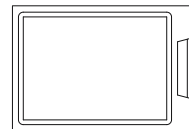

MCB-651BB
Cutting Board

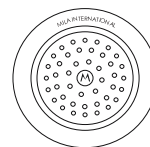

MKD-101GDSB
Strainer

PROJECT INFORMATION			
Project			
Date	/ /	QTY	
Specifier			
Contact			
Note			