

FLATIRON MUS-657GPSB



*Custom ADA compliant versions are available

• FEATURES

16-gauge type 304 stainless steel
90° zero radius design

• TECHNICAL INFORMATION

External dimension: 38"Lx18.5"Wx10"D
Basin dimensions: 36"Lx16.5"Wx10"D

• FINISHES

Graphite PVD Satin Brushed stainless steel

• INSTALLATION OPTIONS

Top-mount
Under-mount

• MINIMUM CABINET SIZE (I.D.)

Top-mount 40"
Under-mount 42"

• DUAL-MOUNT INSTALLATION

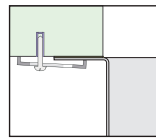

Under-mount

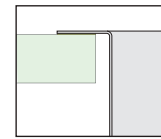

Top-mount

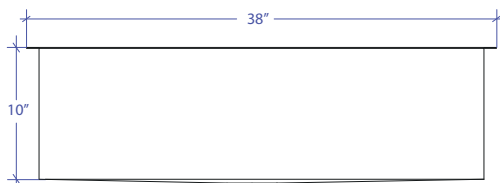
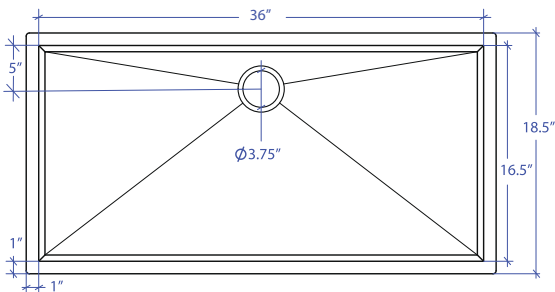

• ACCESSORY OPTIONS

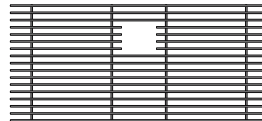

MBG-6518GDSB
Basin Grid

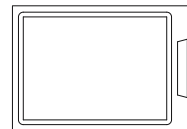

MCB-651BB
Cutting Board

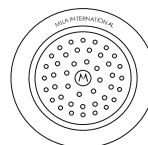

MKD-101GDSB
Strainer

PROJECT INFORMATION			
Project			
Date	/ /	QTY	
Specifier			
Contact			
Note			