



neelnox

LET
THERE
BE **DESIGN.**

FEATURES

- Premium 304 Grade Stainless Steel
- Flushmount Profile
- Equipped with SoundDefy™ noise concealing technology
- Sloped bottom ensures proper drainage of water
- Y I B O N D adhesive included to tile the back of the shelf as per client's preference
- Optional Top Mount Installation as per client's preference
- Fillers provided to Flushmount with tiles of thicknesses 4mm, 6mm, 8mm, 10mm & 12mm
- No installation hardware required



Y-63P

Y-SHELF

SERIES ORIGIN

Model	Product		Finishes Available
Y-63	Y SHELF		Multiple finishes available. 17 Luxurious finishes to choose from.
FINISHES	Polished (-P)	Brushed Bronze (-BBRZ)	Light Beige (-LTBGE)
	Brushed (-B)	Antique Brass (-ABRS)	Grey (-GRAY)
	Brushed Gold (-BGLD)	Antique Copper (-ACOP)	Beige (-BEIGE)
	Matte Black (-BLK)	Matte White (-WHT)	Polished Gold (-PGLD)
	Oil Rubbed Bronze (-ORB)	Brushed Black (-BRBLK)	Polished Rose Gold (-PRGD)
	Brushed Brass (-BBRS)	Brushed Rose Gold (-BRGD)	

Model	Profile	Size (Niche)	Size (Outer)	Rim	Depth	Bottom Slope
Y-63	Flushmount	7 ³ / ₄ x 19 ¹ / ₄ inches 198 x 490 mm	9 x 60 inches 229 x 1524 mm	5/8 inches 15 mm	3 ³ / ₄ inches 97 mm	3/16 inches 5 mm

Product as shown in polished finish



Y-63P

Dimension in inches

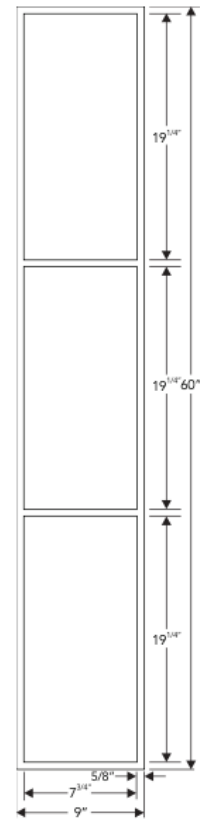

Installation Notes

Cut out size : 8 x 59 inches

NOTE: Dimensions subject to change without notice.